

Flexible New Pivoting Edge Clamps Convert Easily From Manual to Hydraulic

Ideal for Holding TALL Workpieces Or Castings



The pivoting jaw exerts clamping force forward and downward at the same time.

Extremely Versatile for Multiple Applications: One Clamp, Manual or Hydraulic Operation

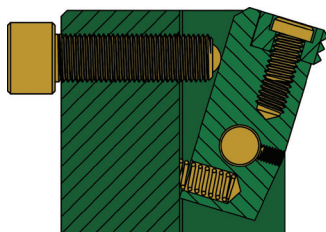

Manual operation

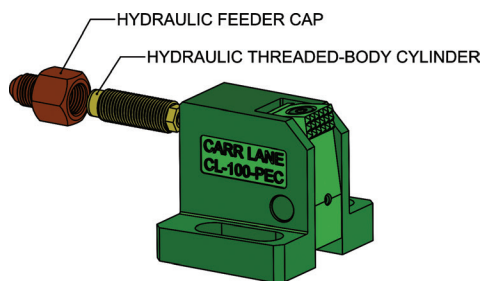

**Hydraulic operation with
an easy conversion. See
reverse side for details.**



CarrLane[®]
MANUFACTURING CO.

Carr Lane Mfg. Co.
314.647.6200
www.carrlane.com

Manual Operation

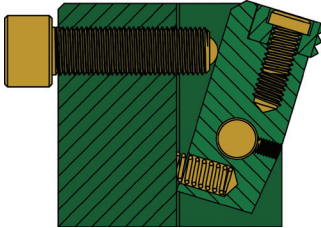

This edge clamp is well suited for holding large castings and other tall workpieces. The pivoting jaw exerts clamping force forward and downward at the same time. The jaw has a replaceable serrated gripper made of hardened tool steel for high-production durability. The slotted base provides adjustability and has a tapered top surface to prevent the clamp from moving. Fasten with two Socket-Head Cap Screws.

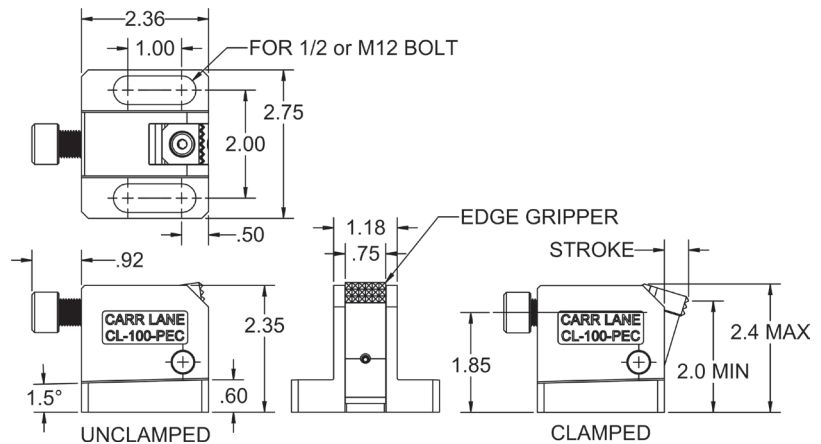

PIVOTING EDGE CLAMP

PART NO.	MAXIMUM CLAMPING STROKE	MOUNTING SCREW SIZE	THRUST SCREW SIZE	BALL-END THRUST SCREW (FURNISHED)	EDGE GRIPPER (FURNISHED)
CL-100-PEC	1/2	1/2-13 or M12	1/2-20	CL-80-BT5-1.75	CL-12-EG-6

Easily Convert to Hydraulic Operation

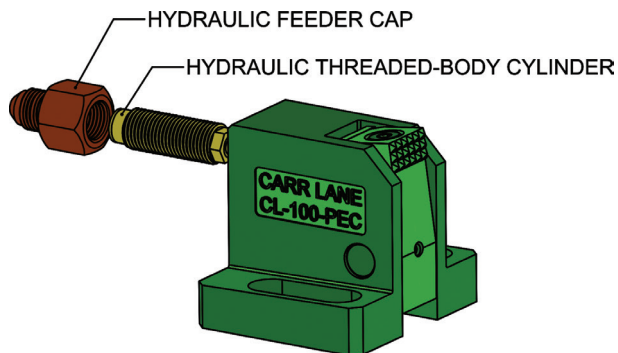

These Pivoting Edge Clamps can be easily converted to hydraulic operation by replacing the standard thrust screw with a Threaded-Body Cylinder and Feeder Cap, then connecting to a hydraulic pressure source. Please see table below for the required conversion accessories. Maximum clamping stroke is reduced to 1/4" when the clamp is converted to hydraulic operation.

HYDRAULIC CONVERSION ACCESSORIES

PART NO.	ITEM DESCRIPTION	MAXIMUM HYDRAULIC PRESSURE (psi)
CLR-802-TB	Hydraulic Threaded-Body Cylinder	7250
CLR-308-TBA	Hydraulic Feeder Cap	7250